

MARK

ANOTHER
ARCHITECTURE

MARK #5

DEC 2006 / JAN 2007

EUROPE €19.95 / UK £ 14
JAPAN ¥ 3,570 / KOREA 40,000 WON
CANADA \$ 29.50 / USA \$ 24.95

BY THE MAKERS OF
FRAME

FRAME

NEUTELINGS
RIEDIJK ON TV

BY

FRAME

ALSO STARRING:

RANDOM PILES OF BOXES
HERZOG & DE MEURON
CAUSES CHAOS

CELEBRATING WATER
FLOATING POOL IN AUSTRIA

NOT AFRAID OF BEAUTY
WORK BY DURBACH BLOCK

GOING EAST

- MODEL VILLAGE IN KOREA
- COPYCATS IN CHINA
- PARTY HOUSE IN JAPAN



I LIKE DALKI

I LIKE DALKI
THEME PARK
MOON-GYU CHOI,
MINSUK CHO AND
JAMES SLADE
2002

PHOTO BY YONG-KWAN KIM



DALKI'S ROOF GARDEN.

Invented to market fashion products, Dalki is a cartoon character who lives in a garden with her friends. Dalki Theme Park is a complex where these characters interact with visitors in a space for shopping, playing, eating and lounging. Learned dichotomies



culture/commerce) and differences in scale create 'disbelief' and impede users from fully engaging in this imaginary world. The building is a synthetic hyper-representation of nature that both mimics and questions 'the nature of nature'. Sculpted floor planes allow the various levels of the complex to merge into one another and into the site, creating a seamless transition between zones: interior to exterior,

stacking provides users with short cuts, permitting them to move easily from one space/programme to another.



VIEW FROM THE SOUTHEAST.

VIEW FROM THE NORTHWEST.

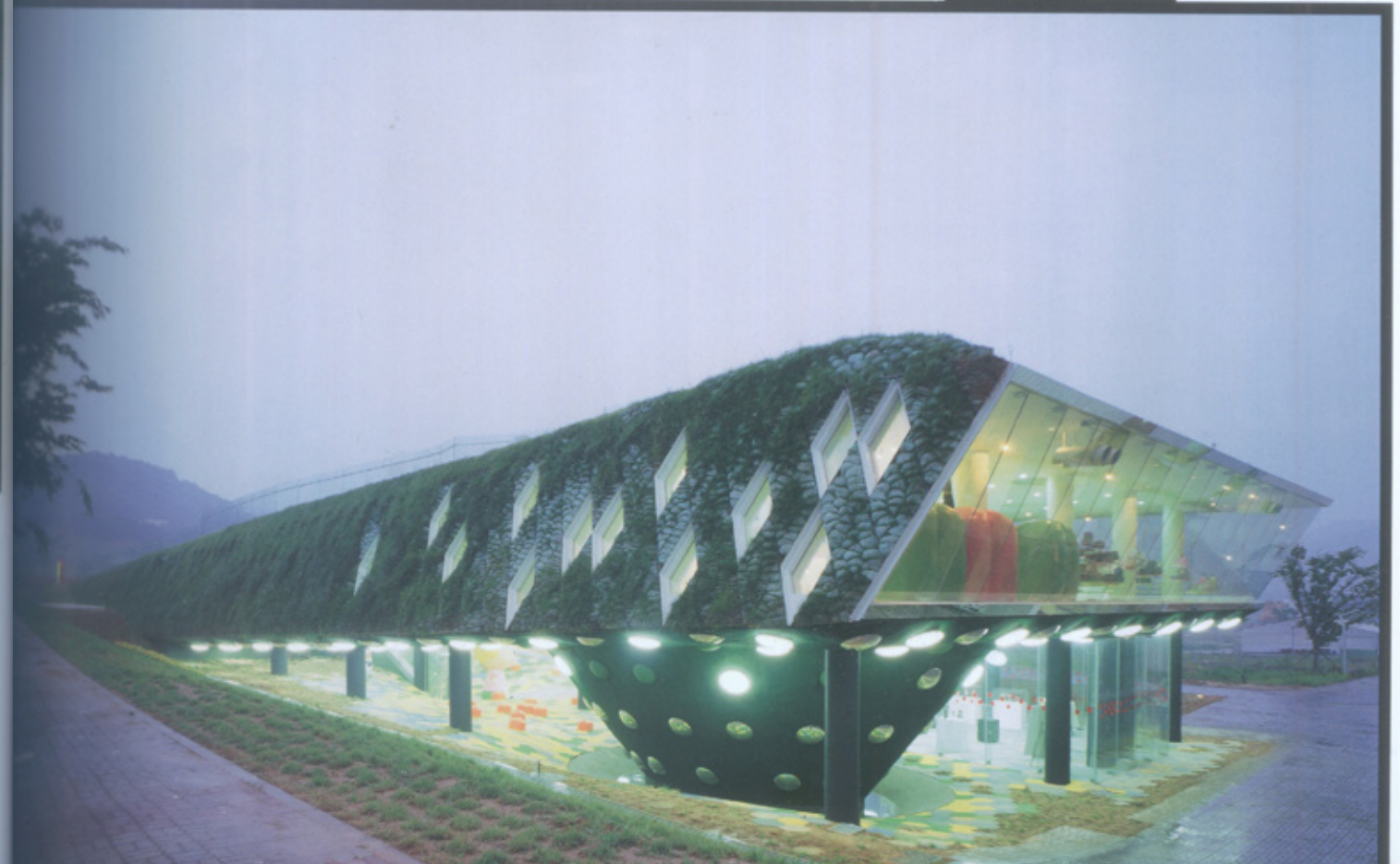

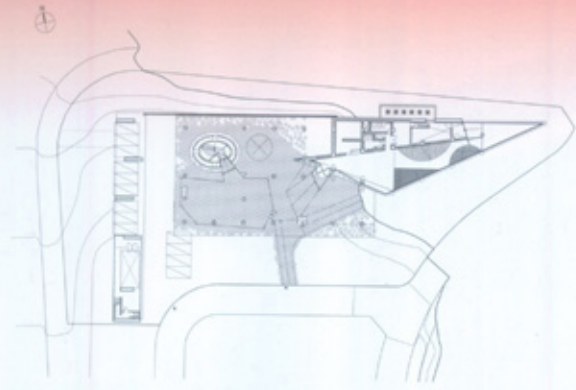

GROUND FLOOR.

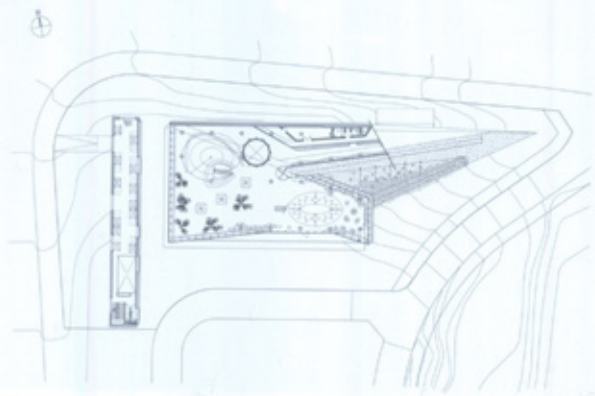

FIRST FLOOR.

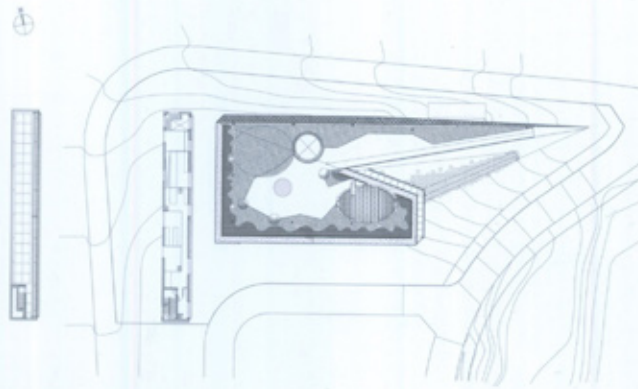

ROOF PLAN.



SECTION.

